

## LEVEL INDICATOR PFG05ATF

Product Line: **ROTARY**

Level indicator suitable for operating in **high temperature** environments. All parts in contact with the measured material are made of stainless steel. Version for flange connection with a maximum temperature inside the silos of **200°C**.

### ADVANTAGES

- An **EASY TO INSTALL** instrument that does not require any calibration, maintenance or specific tool for its installation.
- Thanks to the wide choice of paddles, all of which are interchangeable, it is **ADAPTABLE** to the different densities of the measured materials.
- Extremely **VERSATILE**, it can be installed on tanks, hoppers, on walls or roofs of silos, in a vertical, horizontal or oblique position.
- **CUSTOMIZABLE** with paddles, extensions, voltages and different electrical connection options.
- **DURABLE** and **RELIABLE** with ALUMINIUM casing, stainless steel shaft on ball bearings and electrical connection via anti-vibration faston terminals. Works with ambient temperatures from -20° to +70°C.
- On request:
  - Condensation Filter:** helps preventing the formation of condensation in the level indicator casing.
  - 8 PULSES** for rotation control: remotely notifying that the level indicator is working correctly.
  - Voltage Control:** to check the correct power supply of the level indicator.
  - Double Contact:** the level indicator will have one additional dry contact.
  - 4 RPM:** to decrease the intervention time of the level indicator.
  - Low Temperatures:** allows the indicator to operate up to -27°C.



Solids



Corrosives



High  
Temperature



ATEX CERTIFICATE FOR DUST ZONE 20/21

# LEVEL INDICATOR

# PFG05ATF

Product Line: **ROTARY**



Solids



Corrosives



High Temperature

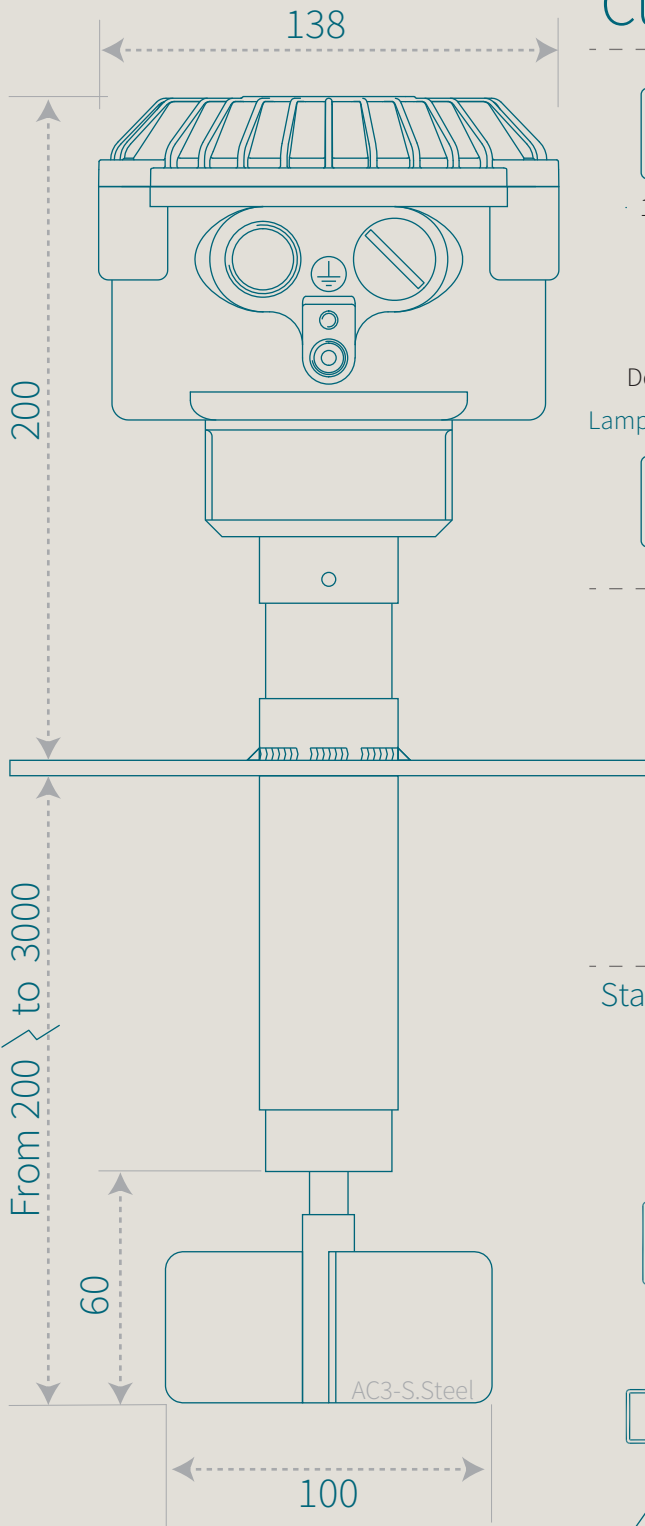

## Customizations



**110/220VAC**

110/220 V AC

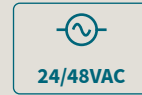

**24/48VAC**

24/48 V AC



**24VDC**

24 V DC



Voltage control



Double contact

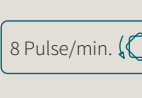

8 pulse



4 RPM



Low temperatures

Lamp



**220VAC**



**110VAC**



**48VAC**



**24VAC**



**24VDC**

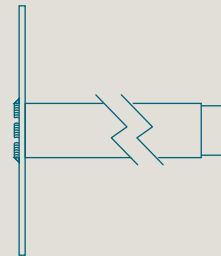

Stainless steel shaft extension with protection from 200 to 3000 mm

## Stainless steel



AC1



AC3



AC4



AC5



AC5L

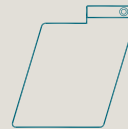

AC6



AC7



AC8

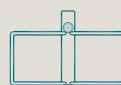

AC9



AC10



AC11



AC12



AC14

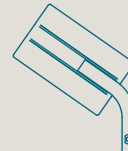

AC15

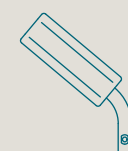

AC16

